



STE PACKAGING DEVELOPMENT



EXTEMPORÁNEO MR1



EXTEMPORÁNEO MR1

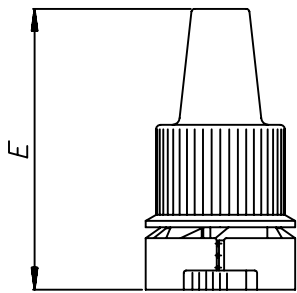

TAPÓN TPMR1

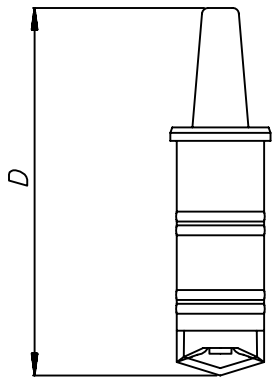

DOSIFICADOR
CORTANTE DCMR1

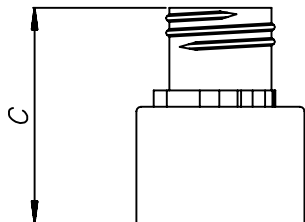

RECIPIENTE
SUPERIOR RSMR1

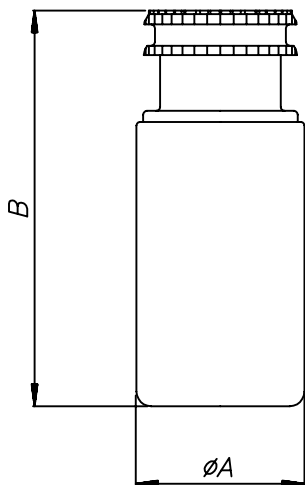

RECIPIENTE
INFERIOR RIMR1

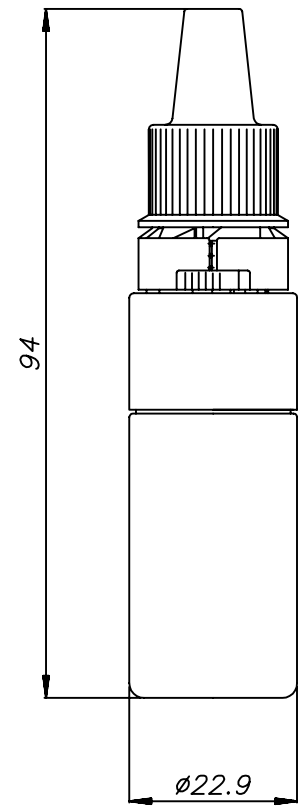

| | COTA (mm) |
|-----|-----------|
| Ø A | 22.9 |
| B | 54 |
| C | 29.3 |
| D | 50.1 |
| E | 38.3 |

| | | PESO (gr) | MATERIAL | |
|-------|---------------------------|-----------|----------|------|
| | CAPACIDAD HASTA EL HOMBRO | TPMR1 | 1.95 | PEHD |
| | | DCMR1 | 1.7 | PS |
| RIMR1 | 12 ml | RSMR1 | 2.1 | PEHD |
| RSMR1 | 2.5 ml | RIMR1 | 4.15 | PELD |